

## SUITABLE FOR MODEL



## COMPONENT SUMMARY

Part	Qty.
Retrofit housing	1
Installation Bracket	2
Installation instruction	1
Lable	1

The Existing luminaries housing shall be larger than dimensions described in below table:

Housing Designation	Luminaire overall dimensions unit:mm
1"x4"	1216mm by 302mm by 80mm high
2"x2"	606mm by 606mm by 79mm high
2"x4"	1216mm by 606mm by 79mm high

## Operating Instructions

Please read and save these instructions. Read through this owner's manual carefully before using product. Protect yourself and others by observing all safety information, warnings, and cautions. Failure to comply with instructions could result in personal injury and/or damage to product or property. Please retain instructions for future reference.

## CAUTION

READ AND FOLLOW ALL SAFETY INSTRUCTIONS.

1. All electrical connections must be in accordance with local codes, ordinance, and the National Electric Code. If you are unfamiliar with methods of installing electrical wiring, secure the services of a qualified licensed electrician.  
Before starting the installation, disconnect the power by turning off the circuit breaker or by removing the appropriate fuse at the fuse box. Turning the power off using the light switch is not sufficient to prevent electrical shock.  
Two people recommended for installation  
Do not use outdoors.  
Remove wiring, lampholders, ballasts, or any other electrical components  
Min lamp compartment dimensions (See pg.1 for kit dimensions)  
Equipment should be mounted in location and at heights where it will not readily be subject to tampering by unauthorized personnel.  
Do not use this equipment for other than intended use.  
All servicing should be performed by qualified personnel only.  
Risk of fire or electric shock. Install this kit only in the luminaires that has the construction features and dimensions shown in the photographs and/or drawings.  
Do not make or alter any open holes in an enclosure of wiring or electrical components during kit installation  
Risk of fire or electric shock. Reflector kit installation requires knowledge of fluorescent lighting luminaires electrical systems. If not qualified, do not attempt installation. Contact qualified electrician.

Installation of this retrofit assembly requires a person familiar with the construction and operation of Fluorescent Luminaire electrical systems and the hazard involved.  
Unless otherwise indicated, do not make or alter any openings in the compartment of wiring or electrical components during installation of this retrofit assembly. Plug all unused openings in the compartment of wiring or electrical components

## WIRING

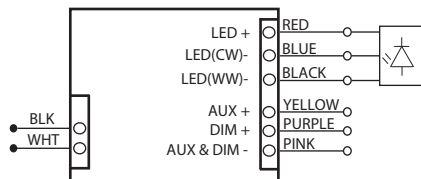

To prevent wiring damage or abrasion, do not expose wiring to edges of sheet metal or other sharp objects

Disconnect the power by turning off the circuit breaker or by removing the appropriate fuse at the fuse box. Turning the power off using the light switch is not sufficient to prevent electrical shock.

## INSTALLATION

1. Disconnect all incoming power to fixture. Remove existing hardware (lens/lens frame, parabolic louver, reflectors/ballast covers, brackets, lamps holders). Leave supply and grounding leads. (Fig.1)

Figure 1

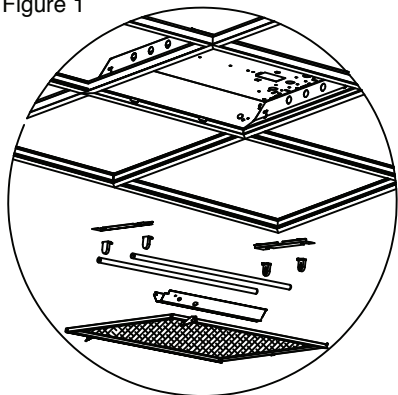

2. Install LED panel end brackets to each end of the existing fixture by gently lifting it and placing LED panel end brackets between the fixture and T-grid. (Fig.2)

Figure 2

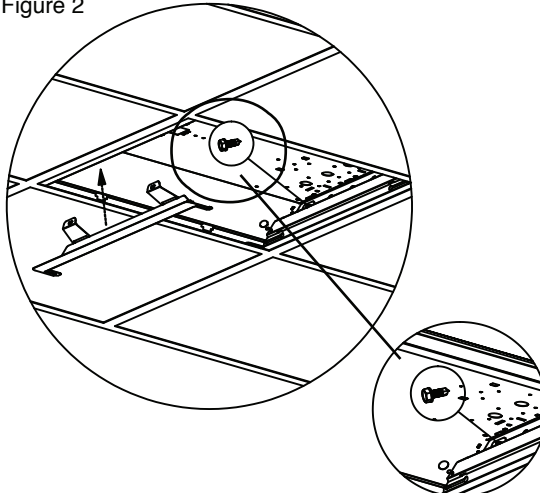
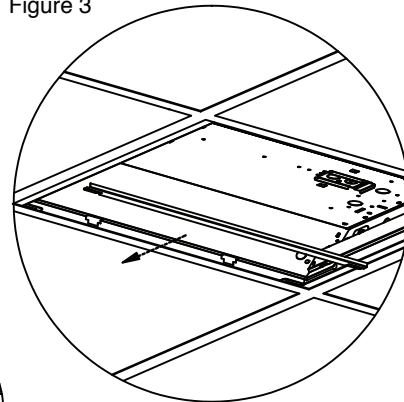

Figure 2A

3. If you are not pleased with the gap between the fixture and T-grid, you may install LED panel side brackets between the fixture and T-grid, there are two tabs to allow for placing the side brackets into the slot of end brackets. (Fig.3)

Figure 3



4. Secure the LED panel brackets to the existing fixture using the provided #8x1/2" self-drilling screws. (Fig.2A) Locate the door assembly body onto the keyholes of end brackets, and then slide the door assembly body horizontally to the end of slots. (Fig.4)

Figure 4

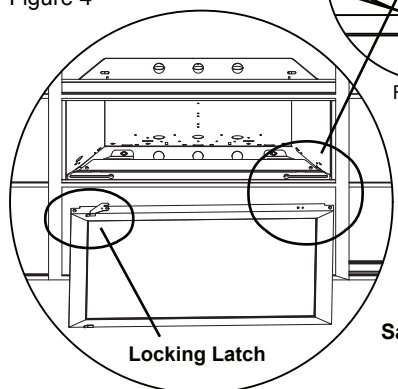

5. Hook the safety cables into the holes positioned the end brackets. Use the provided wire caps to connect the wire leads of the troffer kits to the main power leads. (Black-Live, White-Neutral, Green-Grounding) (Fig.5 & Fig.5A)

Figure 5

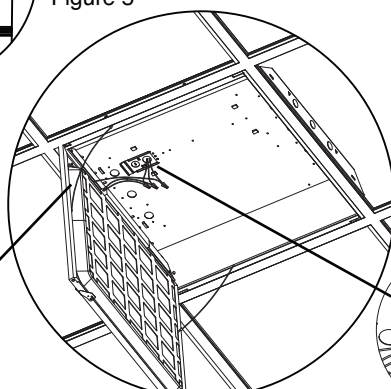

6. Secure the door assembly body by lock the latches riveted on each end of the assembled door frame. (Fig.6)

Figure 6

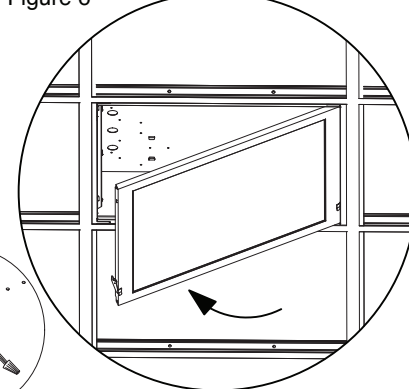

Figure 5A

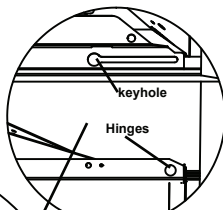

Figure 4A

Safety cable

Locking Latch

## Field-Adjustable Wattage & CCT

Notice: Always disconnect or turn off the power before adjustment.

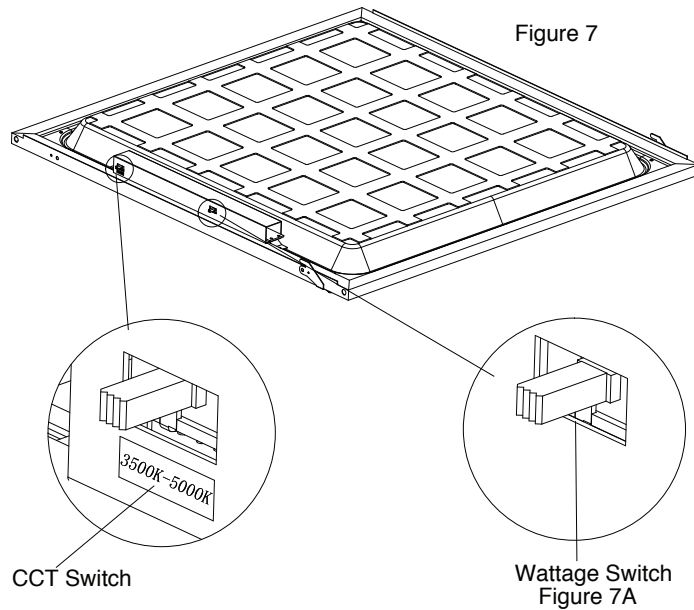

The end users may adjust the color temperature and lumen output respectively by the two DIP switch. Each DIP switch is accommodated with 3 options (left, middle and right), corresponding to 3 color temperatures and 3 powers respectively, which can perform the desired color temperature and lumen output combination.

Default Setting: 2x2 & 1x4: 25W, 4000K; 2x4: 36W, 4000K.

1. DIP switches are located on the driver side. (Fig.7)
2. Select a wattage and color temperature by sliding switch left or right respectively to the desired value. (Fig.7A)

## SENSOP INSTALLATION (OPTIONAL)

Standalone sensor IFS06R or Bluetooth commissioning sensor IFS108

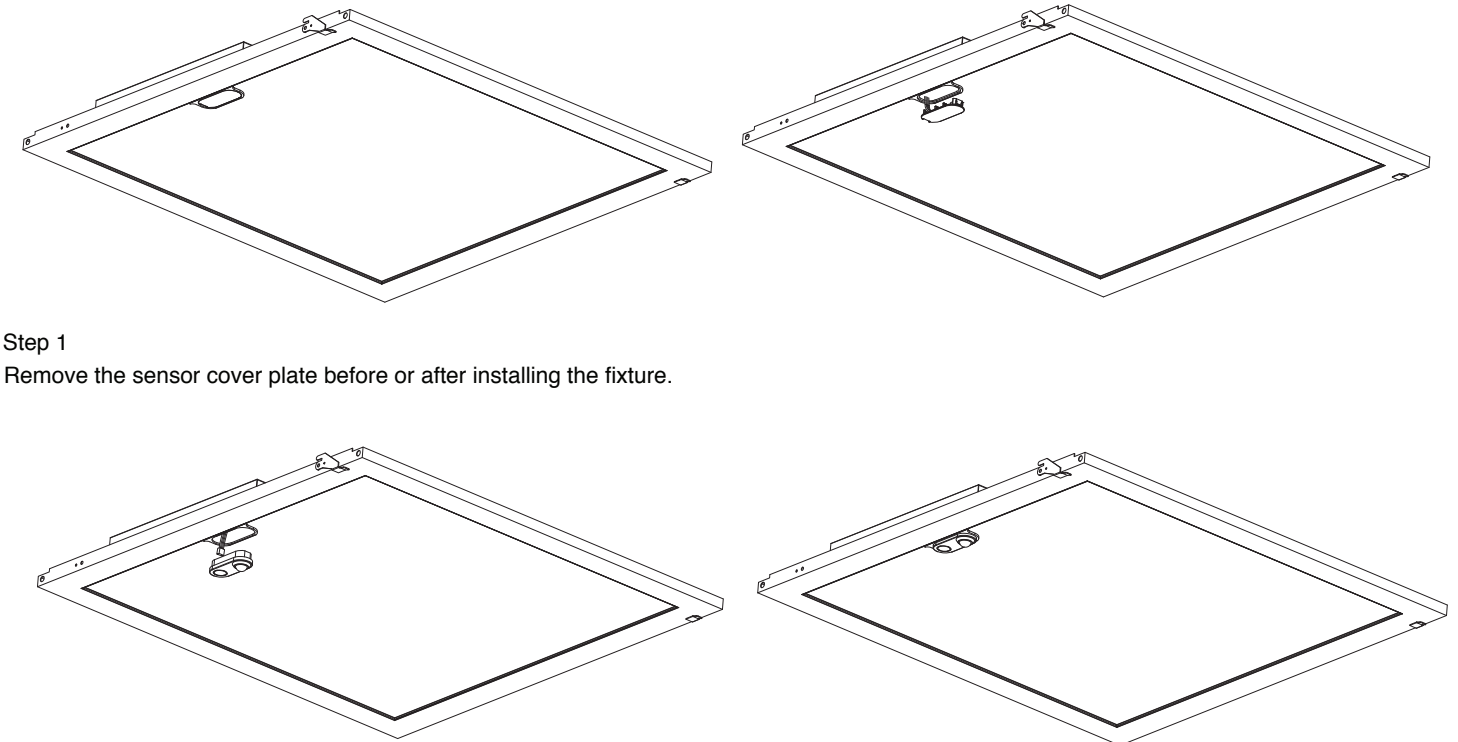

### Step 1

Remove the sensor cover plate before or after installing the fixture.

### Step 2

Remove the flat cable that is secured to the back of the sensor cover plate, then insert the terminals into the approved sensor.

### Step 3

Install the approved sensor and make sure it completely snaps in.